

QT-2000

Versatile Intelligent Terminal

Programming Manual

Version 2.0.0 June 1998

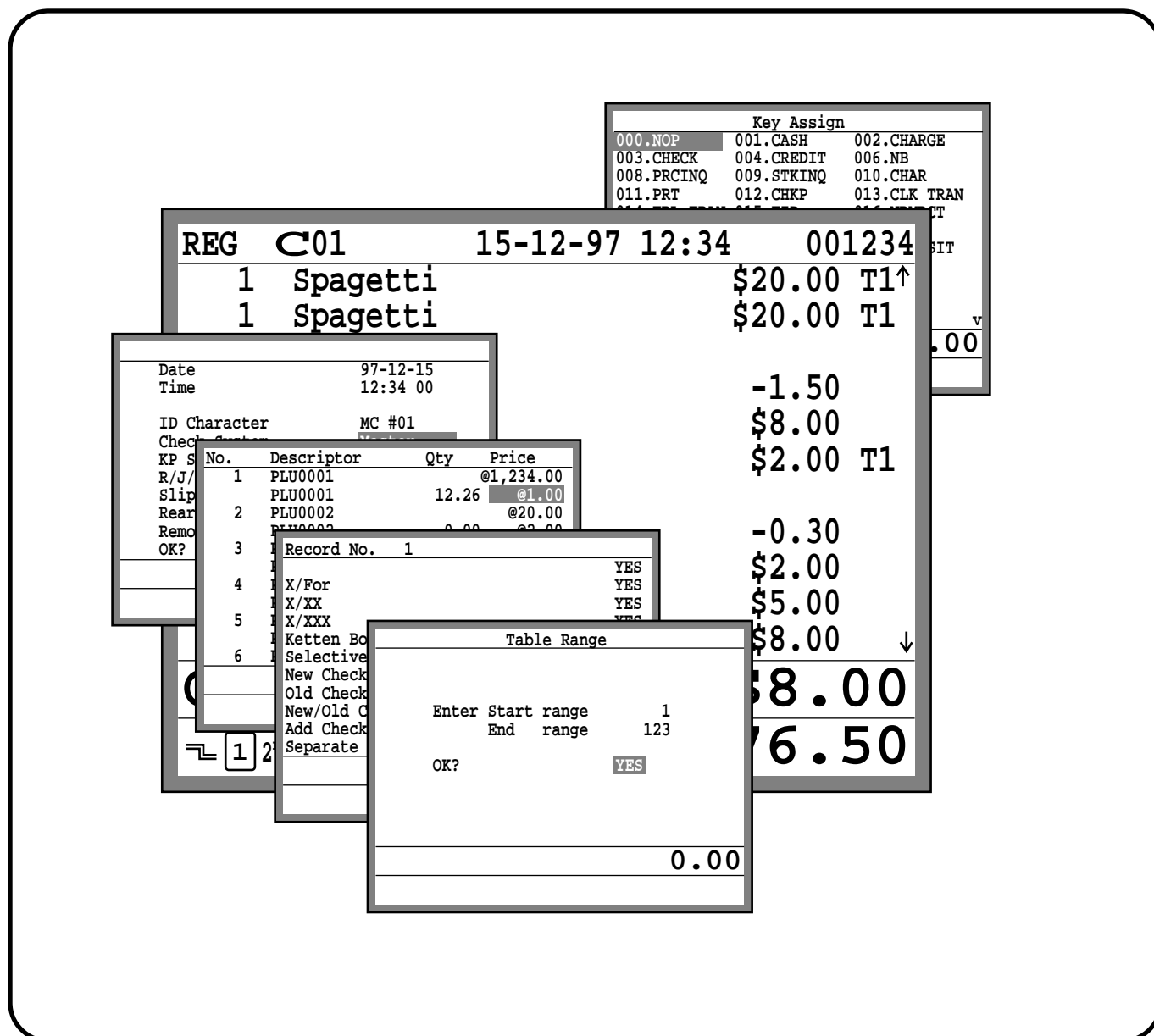

1. Machine Initialization	8
1-1. How to initialize QT-2000 terminal	8
1-2. How to initialize QT-2000 terminal (add/replace one QT-2000)	11
1-3. How to flag clear QT-2000 terminal (INIT2, Restore from flash)	14
2. Program 5	16
2-1. Programming memory allocation (daily & program)	16
2-2. Programming memory allocation (periodic & work)	17
2-3. Programming memory allocation file by file (Method 1)	18
2-4. Programming memory allocation file by file (Method 2)	19
3. Program 4	24
3-1. Programming key allocation	24
3-2. Programming key allocation (key location change)	26
3-3. Programming key allocation (different function on the same location)	28
4. Program 3	32
4-1. Programming machine features	32
4-1-1 Programming pulldown group (adding/modifying/deleting group item)	32
4-1-2 Programming set menu table	34
4-1-3 Programming arrangement	36
4-1-4 Programming batch X/Z report	37
4-1-5 Programming the general feature	39
4-1-6 Programming scheduler	56
4-1-7 Programming check print	58
4-1-8 Programming table analysis	59
4-1-9 Programming tax table	60
4-1-10 Programming void table	62
4-1-11 Programming system connection	63
4-1-12 Programming I/O parameter	64
4-1-13 Programming printer connection	67
4-1-14 Programming time zone	68
4-1-15 Programming Time & Attendance	69
4-1-16 Programming hourly item link	75
4-1-17 Programming IDC link	76
4-2. Programming clerks	78
4-2-1 Programming clerk features	78
4-2-2 Programming operation	80
4-2-3 Programming commission rate	90
4-2-4 Programming table range	91
4-2-5 Programming clerk by range	92
4-2-6 Programming cashier detail	104

4-3. Programming key features	106
4-3-1. Programming PLU features	106
4-3-2 Programming PLU 2nd@ features	108
4-3-3 Programming subdepartment features	109
4-3-4 Programming department features	110
4-3-5 Programming by range	111
4-3-6 Programming individual program	114
4-3-7 Programming key function program	115
5. Program 2	132
5-1. Character programming	132
5-1-1 Character programming keyboard	132
5-1-2 Inputting characters by code	134
5-1-3 After completing to input characters	134
5-2. Programming item descriptors	135
5-2-1 Programming PLU item descriptors	135
5-2-2 Programming PLU 2nd unit price descriptors	136
5-2-3 Programming Subdepartment descriptors	136
5-2-4 Programming Department descriptors	137
5-2-5 Programming PLU/subdepartment/department descriptors by range	138
5-2-6 Copying PLU descriptors to PLU 2nd unit price	139
5-2-7 Programming function key descriptors	140
5-3. Programming characters and messages	141
5-3-1 Programming receipt message, slip message and guest receipt message	141
5-3-2 Programming text recall message	142
5-3-3 Programming order character link	142
5-3-4 Programming fixed totalizer descriptors	143
5-3-5 Programming text recall message	144
5-3-6 Programming special characters	144
5-3-7 Programming report headers	146
5-3-8 Programming endorsement message	147
5-3-9 Programming GT character	147
6. Program 1	150
6-1. Presetting date and time	150
6-2. Programming unit price and rate	151
6-2-1 Programming PLU unit price	151
6-2-2 Programming PLU 2nd unit price	152
6-2-3 Programming PLU unit price and PLU 2nd unit price	153
6-2-4 Programming subdepartment unit price	154
6-2-5 Programming department unit price	154
6-2-6 Programming PLU/PLU 2nd@/subdepartment/department unit price by range	155
6-2-7 Copying PLU unit price to PLU 2nd unit price	157
6-2-8 Programming amount or rate to keys	158

7. Program 6	160
7-1. Program read general procedure	160
7-2. Program read report sample	161
7-2-1. Unit Price/Qty	161
7-2-2. Item Descriptor	162
7-2-3. Character and Message	162
7-2-4. Machine feature	166
7-2-5. Clerk	195
7-2-6. Key feature	207
7-2-7. Keyboard	227
7-2-8. Memory allocation	227
8. Program 7	230
8-1. Program backup	230
8-2. Program restore	231
8-3. J-Memo clear	231
8-4. Data backup list	232
Index	236
Program 3 mode Hierarchy	239
Program 2 mode Hierarchy	240
Program 1 mode Hierarchy	240
Program 6 mode Hierarchy	241

This is a “Table of Contents preview” for quality assurance

The full manual can be purchased from our store:

[https://the-checkout-tech.com/manuals/casio/QT-2000 programming manual.html](https://the-checkout-tech.com/manuals/casio/QT-2000_programming_manual.html)

And our free Online Keysheet maker:

<https://the-checkout-tech.com/Cash-Register-Keysheet-Creator/>

[HTTPS://THE-CHECKOUT-TECH.COM](https://THE-CHECKOUT-TECH.COM)